

IT IS PREFERABLE TO BE ABLE TO TURN THE WATER PRESSURE ON AND OFF.
IF THE WATER PRESSURE IS LOW IT IS POSSIBLE THAT THE HYDRANT WILL BE OPENED WHEN REMOVING THE UPPER

1. MAKE CERTAIN THE HYDRANT IS CLOSED, WATER MAY REMAIN ON, BUT SEE ABOVE NOTE
2. REMOVE THE STEM PIN BACKING SET SCREW(K1709A) AND STEM PIN(K1709) WITH A 5/16" ALLEN KEY(SEE FIGURE 2)
3. REMOVE THE 1/2" SOCKET HEAD CAP SCREWS(K1715) AT THE BREAKER CLAMP(K1717)WITH A 3/8" ALLEN KEY; REMOVE THE CLAMPS
4. TURN THE OP NUT COUNTER CLOCKWISE UNTIL THE UPPER BARREL DISENGAGES FROM THE UPPER STEM
5. LIFT THE UPPER BARREL COMPLETELY OFF THE STEM
6. REMOVE THE BOTTOM PIN FROM THE STEM ASSEMBLY, AND LIFT THE UPPER STEM AND COUPLING(K1713) OFF THE LOWER STEM
7. SLIDE THE EXTENSION COUPLING(K1740) OVER THE LOWER STEM & INSTALL THE EXTENSION STEM(K1739) AS SHOWN IN FIGURE 1; INSTALL UPPER STEM AND BREAKER COUPLING(K1713) ON TO THE EXTENSION STEM, THE BREAKER COUPLING IS ALWAYS ABOVE THE EXTENSION COUPLING
8. ENSURE THE O-RING(K1716) IS INSTALLED IN THE DOVE TAIL GROOVE OF THE EXTENSION BARREL. WIPE THE TOP SURFACE OF THE LOWER BARREL CLEAN, AND PLACE THE EXTENSION BARREL(K1738) ON TOP. VISUALLY CHECK THAT THE O-RING ON THE EXTENSION BARREL IS COVERED BY THE LOWER BARREL.
9. INSTALL THE EXTENSION CLAMPS(K1741) BY TIGHTENING THE 1/2" SOCKET HEAD CAP SCREWS, ENSURE THE CLAMPS ARE FULLY ENGAGED IN THE GROOVE ON THE PIPE.
10. CHECK THE CONDITION OF THE O-RING ON THE BOTTOM OF THE UPPER BARREL(K1716) AND IN THE STEM BUSHING(K1712). LIFT THE UPPER BARREL OVER THE STEM AND GUIDE THE UPPER STEM THROUGH THE STEM BUSHING(K1712). ENGAGE THE OP NUT WITH THE THREADS OF THE UPPER STEM AND TURN CLOCKWISE, ALLOWING THE UPPER BARREL TO LOWER ONTO THE LOWER PIPE. REMOVE OP STOP SET SCREW(K1701A) AND BACK OFF OP STOP(K1701B) WITH 3/8" ALLEN KEY IF THE UPPER DOES NOT LOWER FULLY. IF EQUIPPED, ENSURE THE LOCKING WRENCH(K1731) FITS OVER THE EYEBOLT.
11. MAKE SURE THE O-RING ON THE UPPER BARREL IS COVERED. LOOK THROUGH THE STEM PIN HOLE AND MAKE SURE THE SLOT IS VISIBLE AND ALIGNED. INSTALL THE STEM PIN AND BACKING SET SCREW.
12. ENSURE THE O-RING ON THE UPPER BARREL IS COMPLETELY COVERED BY THE LOWER PIPE. INSTALL BARREL CLAMPS AND TIGHTEN WITH 1/2" SOCKET HEAD CAP SCREWS

PARTS LIST (AVAILABLE IN 6",12",18",24" EXTENSION LENGTHS):

1. K1712-DASH 218 O-RING QTY.2
2. K1714-COUPLING PIN AND BRIDGE PINS-QTY.4
3. K1715-1/2" X 1 3/4" SOCKET HEAD CAP SCREW QTY.4
4. K1716-DASH 260 O-RING QTY. 2
5. K1738-EXTENSION SPOOL QTY.1
6. K1739-EXTENSION STEM QTY.1
7. K1740-EXTENSION COUPLING QTY.1
8. K1741-EXTENSION CLAMP QTY.2

TOOLS LIST (NOT PROVIDED):

1. 3/8" ALLEN WRENCH OR SOCKET
2. 5/16" ALLEN WRENCH OR SOCKET
3. DRIFT(TO ALIGN PIN HOLES)
4. PLIERS
5. HAMMER
6. WIRE BRUSH

REVISIONS				
ECN	REV.	DESCRIPTION	BY	DATE

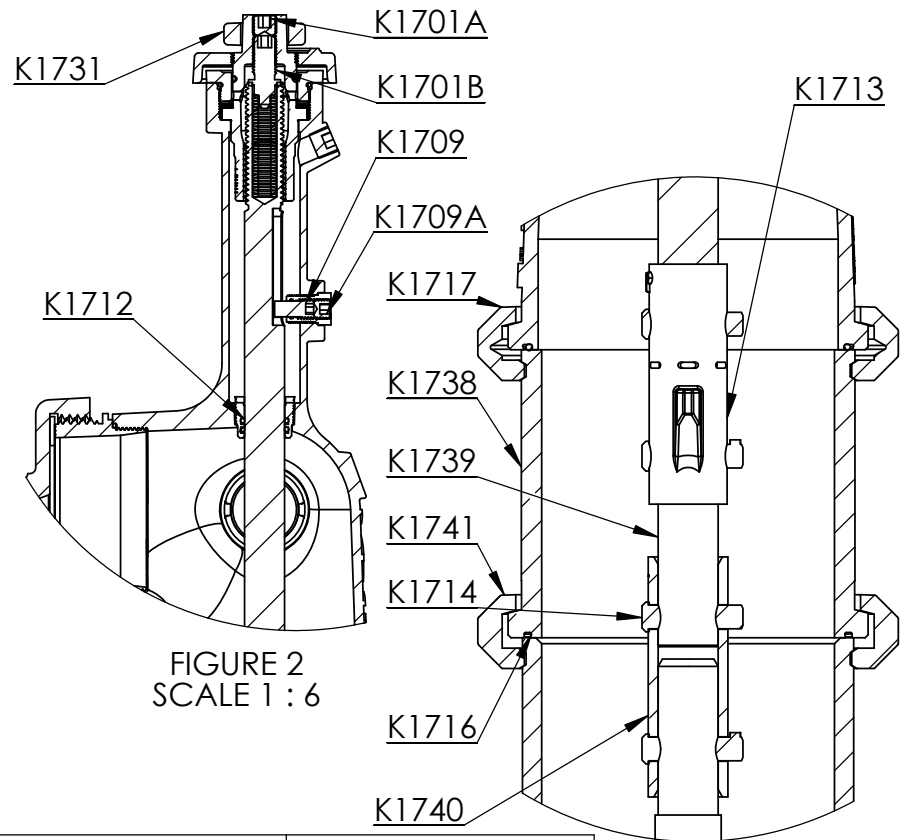

FIGURE 2
SCALE 1 : 6

FIGURE 1

EXTENSION	P/N
6"	1583326952
12"	1583326962
18"	1583326972
24"	1583326982

UNLESS OTHERWISE SPECIFIED: CASTING DIM: 0" - 4" +/- 1/32" 4" - 8" +/- 3/64" 8" - 12" +/- 1/16" 12" - 18" +/- 3/32" 18" - UP +/- 1/8" RADII 1/8" DRAFT 2°		NAME	DATE	KENNEDY VALVE Division of McWane, Inc. 1021 EAST WATER STREET, ELMIRA, NEW YORK 14901
	DRAWN	JEB	9/2/2020	
	CHECKED	LKH	9/3/2020	
	APPROVED			
DO NOT SCALE DRAWING				TITLE: K17 EXTENSION INSTRUCTIONS
MACHINING DIM: DUAL DIM. INCHES[MM] FRACTIONAL ± 1/64 ANGULAR ± .5 RADII ± 1/32" TWO PLACE DECIMAL ± .02 THREE PLACE DECIMAL ± .005	Weight: LBS	MATERIAL:	SIZE A	PART NO. SEE TABLE
FINISH: 125 RMS	PROPRIETARY AND CONFIDENTIAL THE INFORMATION CONTAINED IS THE SOLE PROPERTY OF CO. ANY REPRODUCTION IN PART OR AS A WHOLE WITHOUT THE WRITTEN PERMISSION OF KENNEDY VALVE CO. IS PROHIBITED. DESIGN & INVENTION RIGHTS RESERVED.			DWG. NO. 17068
				REV X1
				SHEET 1 OF 1